

# IGLOO PLUS 89 R290 (COD. E4201S5400)

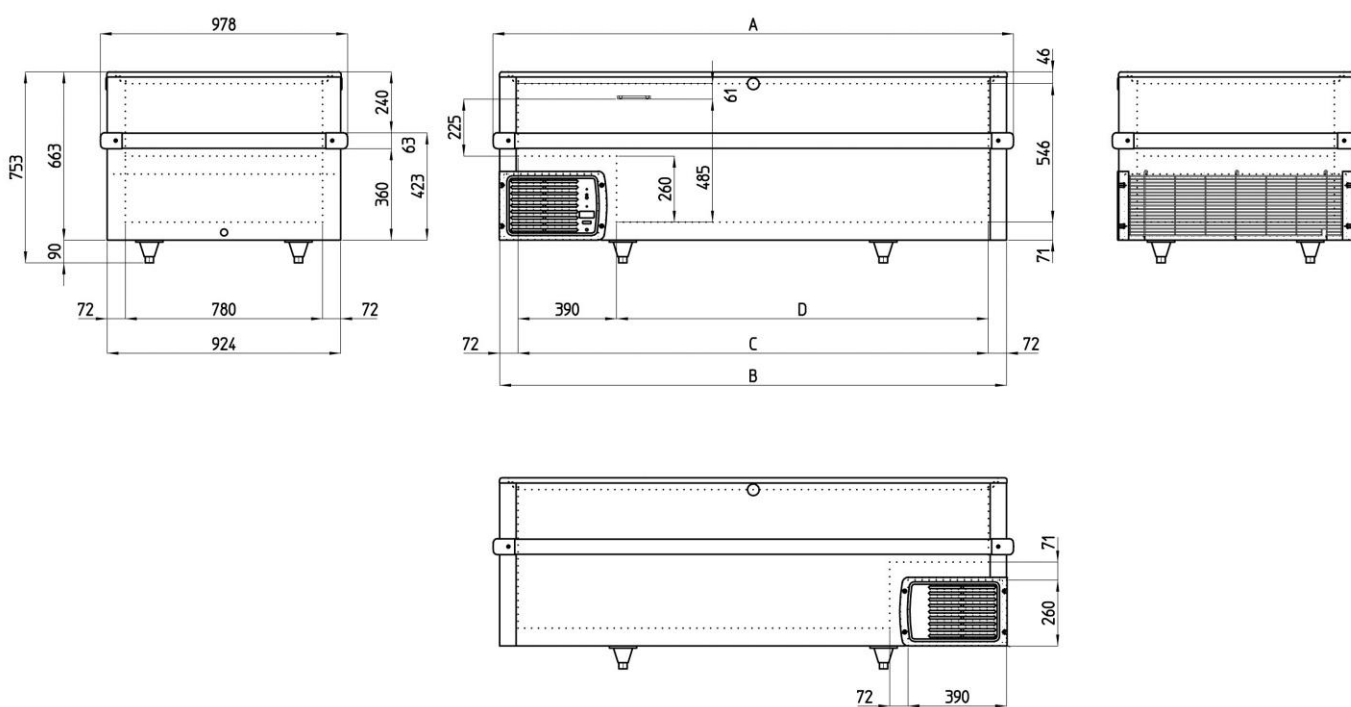

Ice cream and frozen food cabinet

Layout



MODELLO	A	B	C	D
IGLOO PLUS 89	1558	1504	1360	970
IGLOO PLUS 91	2058	2004	1860	1470
IGLOO PLUS 94	2558	2504	2360	1970

IGLOO PLUS 89-91-94

S\_40289 - 00

# IGLOO PLUS 89 R290 (COD. E4201S5400)

Ice cream and frozen food cabinet

Technical data

<b>Temperature</b>	-18°C -25°C
<b>Voltage and Frequency</b>	230 V~ 50Hz
<b>Gas</b>	R290
<b>Net dimension</b>	1558 x 978 x 753 mm (l x p x h)
<b>Packed dimension</b>	1620 x 1040 x 830 mm (l x p x h)
<b>Gross capacity</b>	529 l
<b>Net capacity</b>	435 l
<b>Gross weight</b>	113.00 Kg
<b>Net weight</b>	92.00 Kg
<b>Heat insulation</b>	Rigid polyurethane foam "HCFC/CFC/HFC" free
<b>External cabinet</b>	White prepainted non-toxic steel sheet
<b>Cabinet bottom</b>	Galvanized steel sheet
<b>Inner tank</b>	White prepainted non-toxic steel sheet
<b>Frame</b>	Grey plastic
<b>Glass</b>	2 monolithic sliding top glasses
<b>Handle</b>	Grey plastic
<b>Frontal grid - colour</b>	White plastic
<b>Side grid - colour</b>	White plasticised non-toxic steel rod
<b>Back grid - colour</b>	White plastic
<b>Bumper</b>	Grey plastic
<b>Compressor</b>	3/8 HP
<b>absorbed power</b>	250 W
<b>Power consumption (24h)</b>	..
<b>Condensator</b>	Wire and tube - maintenance free with powered fan
<b>Evaporator</b>	Static evaporator wrapping the tank
<b>Defrosting</b>	Manual
<b>Climatic class</b>	4 (30°C-55%RH) L1
<b>Plug</b>	European - Angular Plug
<b>Thermometer</b>	Mechanical
<b>Thermostat</b>	Mechanical
<b>Standard equipment</b>	4 adjustable feets
<b>Optional</b>	Divider kit for base deck - baskets - wheels kit
<b>Brand</b>	MONDIAL ELITE
<b>Producer brand</b>	MONDIAL GROUP